

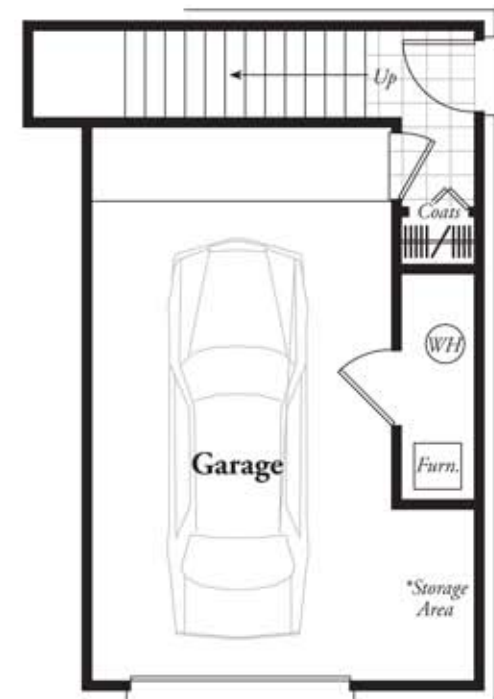

# ASHFORD APARTMENTS



## THE CARRIAGE II

Carriage Level – Approximate Sq. Ft. 1,310

*This cozy two bedroom apartment exudes the essence of carefree living. A stylish stairway opens up into a spacious living room where cathedral ceilings and a focal point fireplace set a tone of casual sophistication. Sliding glass doors lead to a balcony just off the dining room, creating the perfect spot for late evening supper and stargazing. A central hallway leads to a conveniently located laundry area, linen closet and both bedrooms. A cathedral ceiling in the master suite adds an elegant touch while a spacious closet and private bath complete the retreat. The main-level one-car garage provides both ample storage area and easy access to the upper level living area.*

P 586-323-3184 F 586-323-3216  
Located on Dequindre Rd. btwn. Auburn & Hamlin Rds.  
in the Shelby Twp./Rochester Hills Area

These are preliminary plans and are subject to change without notice. Renderings and illustration are artist's concepts and are only representative.

All information contained herein was accurate at time of publication. In order to maintain a high degree of quality and incorporate improvements with greater facility and economics, we reserve the right to make changes in price, material specifications or materials or to change or discontinue models without notice or obligation. Floor plan dimensions and square footage are approximate. Square footage calculated from exterior wall, master deed reflects interior dimensions.

© Copyright Ashford Apartments LLC and architect copyright floor plans and elevations. Any use without approval by Ashford Apartments LLC shall be subject to prosecution.

