

Chesterfield III

1,470 Sq. Ft. Ranch

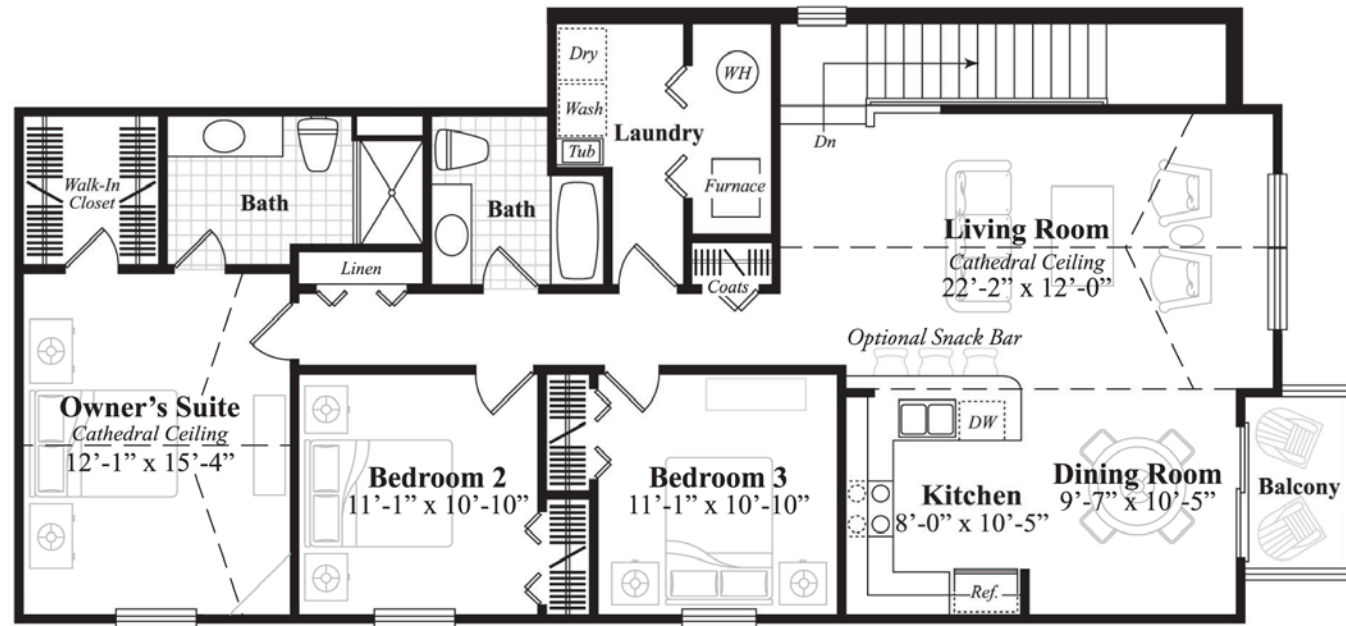

Second Floor

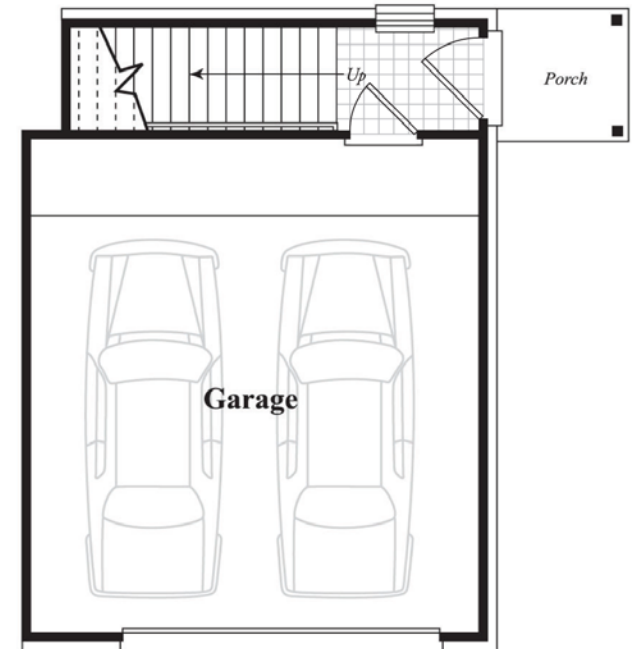

First Floor

This cozy 3-bedroom condominium home exudes the essence of carefree living. A covered porch opens to the staircase leading up to a spacious living room with a soaring cathedral ceiling. Sliding glass doors reveal a balcony just off the dining room, creating a perfect spot for a late evening supper and stargazing. The convenient laundry area is just steps from a full bath, handy linen closet and the bedrooms. A cathedral ceiling in the owner's suite adds an elegant touch, enhanced by the walk-in closet and private bath. The main level two-car garage provides both ample storage space and easy access to the upper level living area.

(586) 469-1261
www.mjccompanies.com

