

INNSBROOK III

First Level	1,330 sf
Second Level	1,149 sf
Total	2,479 sf

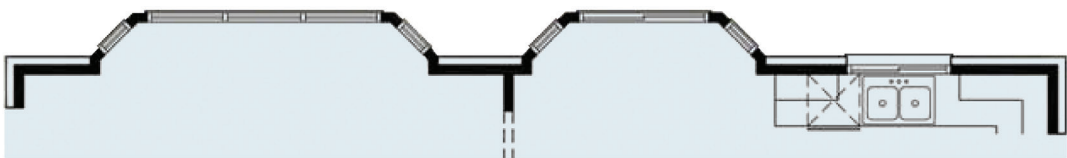

The Innsbrook III colonial has a charming traditional feel with its welcoming covered front porch. Equipped with a dining room and library on the first floor and four bedrooms on the second; each space is functional and designed with individual privacy in mind. The owner’s suite includes a detailed tray ceiling, spacious bath with soaking tub, twin vanities and walk-in closet. The Innsbrook III lives large — thanks to the open plan of the family room, nook and island kitchen. The two-car garage opens to a convenient mud room with an adjoining laundry room.

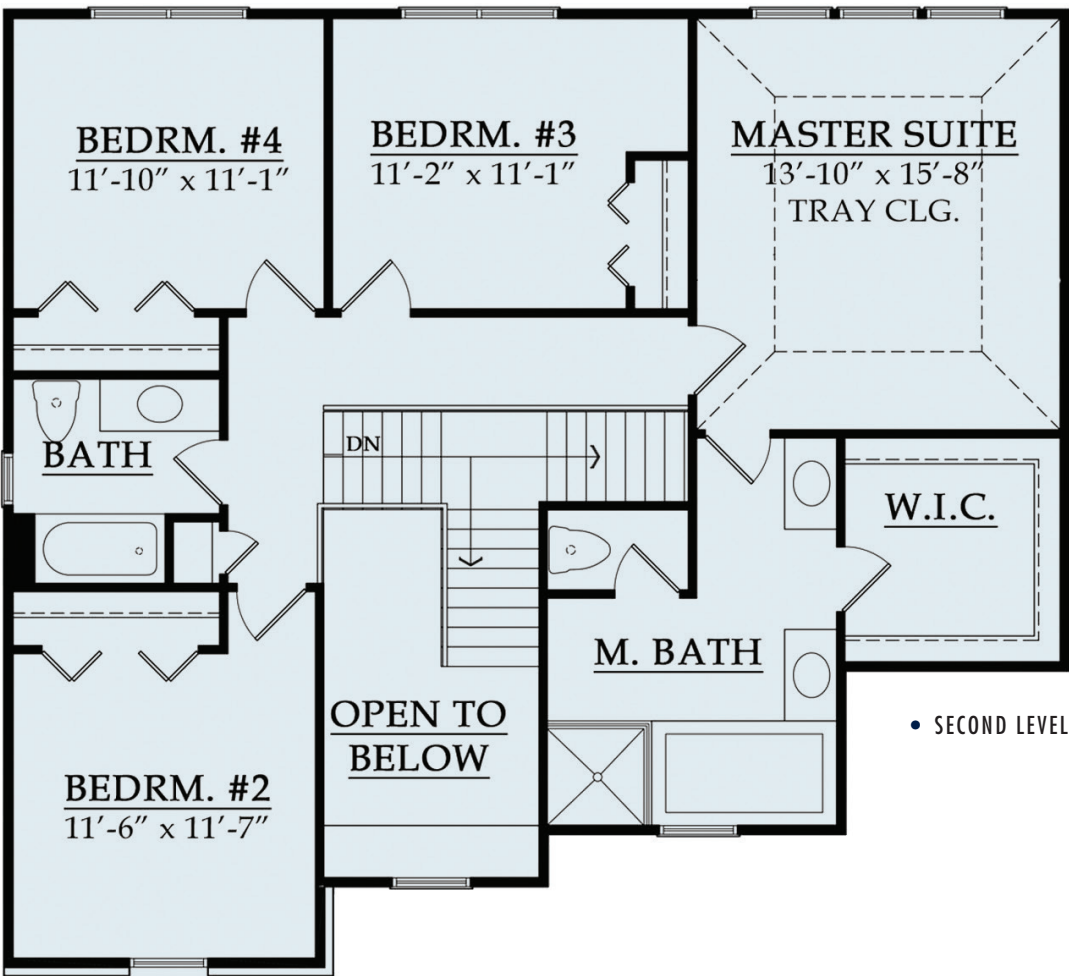

• OPTIONAL BAYS @ FAMILY ROOM AND NOOK

