



HUNTERS RIDGE
LANDINGS

BERETTA (LOFT)

First Level	1,451 sf
Second Level	294 sf
Total	1,745 sf

Welcome To The Landings...

For those who seek a brand new home — where lawn care, snow removal and other time-consuming chores are handled by the homeowner's association, the Landings is a wise choice.

This is a unique opportunity for you to own a spacious home with modern design, two-car garage, full basement and private patio or balcony at a surprisingly affordable price.

The Landings provides all these benefits, plus excellent Hartland Schools, lower township taxes and a highly accessible location. Best of all, you are just steps away from the Shops at Waldenwood, the area's premier retail center.

BERETTA (LOFT)

First Level 1,451 sf
 Second Level 294 sf
 Total 1,745 sf

The Beretta evokes all the qualities one comes to expect from the perfect ranch condo with the additional second floor bedroom, private full bath and large walk-in closet. Open design with 9-foot ceilings and the option of a cathedral ceiling add to the captivating appeal. The great room, dining room and kitchen are all flooded with natural light. A L-shaped kitchen with an island snack bar flows into the dining room which connects to the outdoor patio or balcony. Need a place to run the household, add the optional central command center.

The owner's suite includes a private bath and oversized walk-in closet. The second bedroom adjoins another full bath. A two-car garage leads directly into the first floor laundry room. Need additional living space, the full basement can be finished to give you the room you need.

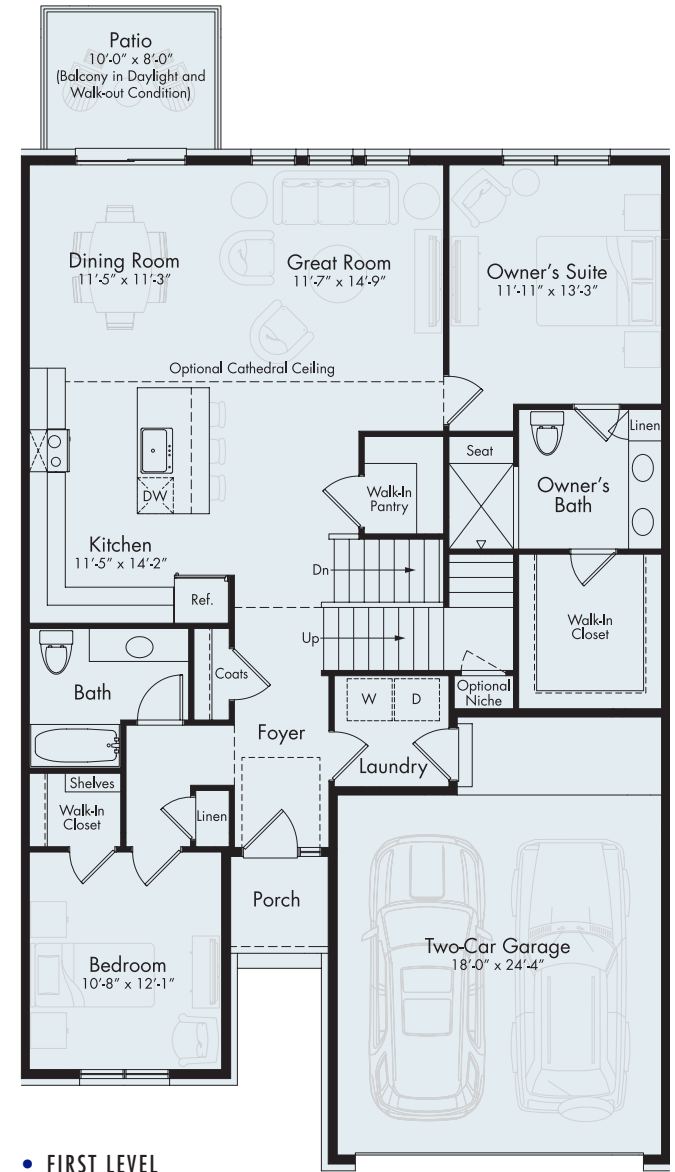
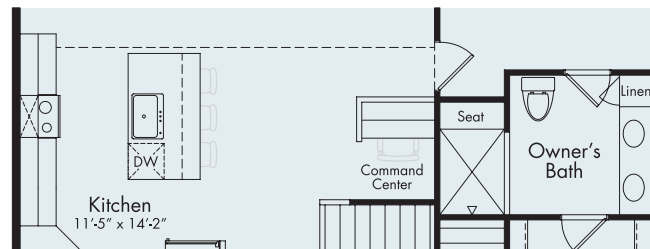
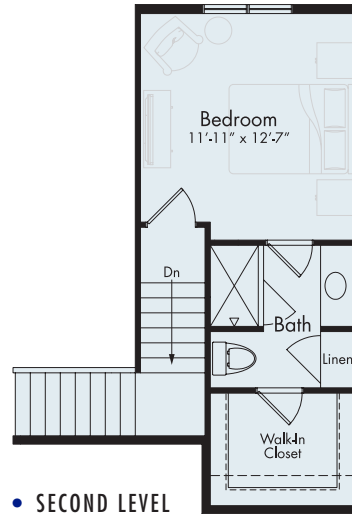

MJCCompanies.com

All information contained herein was accurate at the time of publication. In order to maintain the high degree of quality and incorporate improvements with greater facilities and economy, we reserve the right to make changes in price, specifications, or materials or to change or discontinue models without notice or obligation. Floor plan dimensions are approximate. Renderings are artist's conception. 082222 © 2022 MJC Fox Ridge LLC

