

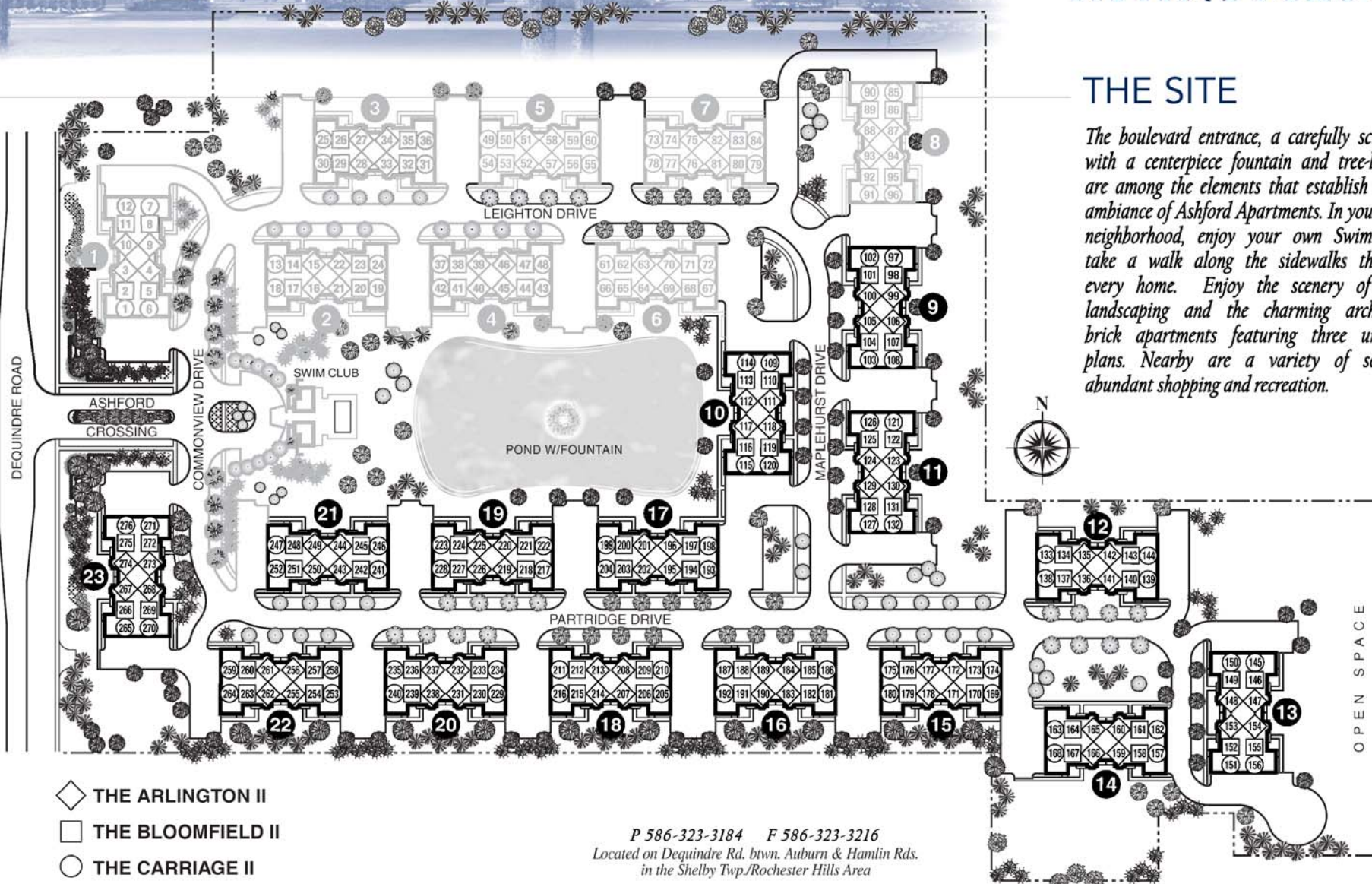

ASHFORD APARTMENTS

THE SITE

The boulevard entrance, a carefully sculpted pond with a centerpiece fountain and tree-lined streets are among the elements that establish the inviting ambiance of Ashford Apartments. In your immediate neighborhood, enjoy your own Swim Club or take a walk along the sidewalks that pass by every home. Enjoy the scenery of meticulous landscaping and the charming architecture of brick apartments featuring three unique floor plans. Nearby are a variety of services and abundant shopping and recreation.



OPEN SPACE

- ◆ THE ARLINGTON II
- THE BLOOMFIELD II
- THE CARRIAGE II

P 586-323-3184 F 586-323-3216
 Located on Dequindre Rd. btwn. Auburn & Hamlin Rds.
 in the Shelby Twp./Rochester Hills Area

These are preliminary plans and are subject to change without notice. Renderings and illustration are artist's concepts and are only representative.

All information contained herein was accurate at time of publication. In order to maintain a high degree of quality and incorporate improvements with greater facility and economics, we reserve the right to make changes in price, material specifications or materials or to change or discontinue models without notice or obligation. Floor plan dimensions and square footage are approximate. Square footage calculated from exterior wall, master deed reflects interior dimensions.

© Copyright Ashford Apartments LLC and architect copyright floor plans and elevations. Any use without approval by Ashford Apartments LLC shall be subject to prosecution.

